

**TEMPORARY DIVERSION & CLOSURE OF SILK HIGHWAY AT SUNGAI LONG (KM12) FROM 26 HB NOVEMBER 2017 UNTIL 20HB MAC 2018 FOR BRIDGE CONSTRUCTION WORKS.**

SELANGOR - EKVE Sdn Bhd is announcing the closure of the right lane for both bound of the two-way leading to the Semenyih and Balakong, Silk Highway at KM 12, Sg Long starting from **26<sup>th</sup> November 2017 to 20<sup>th</sup> March 2018** for the construction work of the bridge for EKVE Highway.

The closure will be carried out 24 hours a day until the end of March 2018.

All road users are advised to observe the road signages and to drive carefully within the area.

For inquiry, please contact EKVE Hotline 1-300-88-3583 or the Project Director at 019-227 2267.

Any inconvenience is regretted. Thank you.

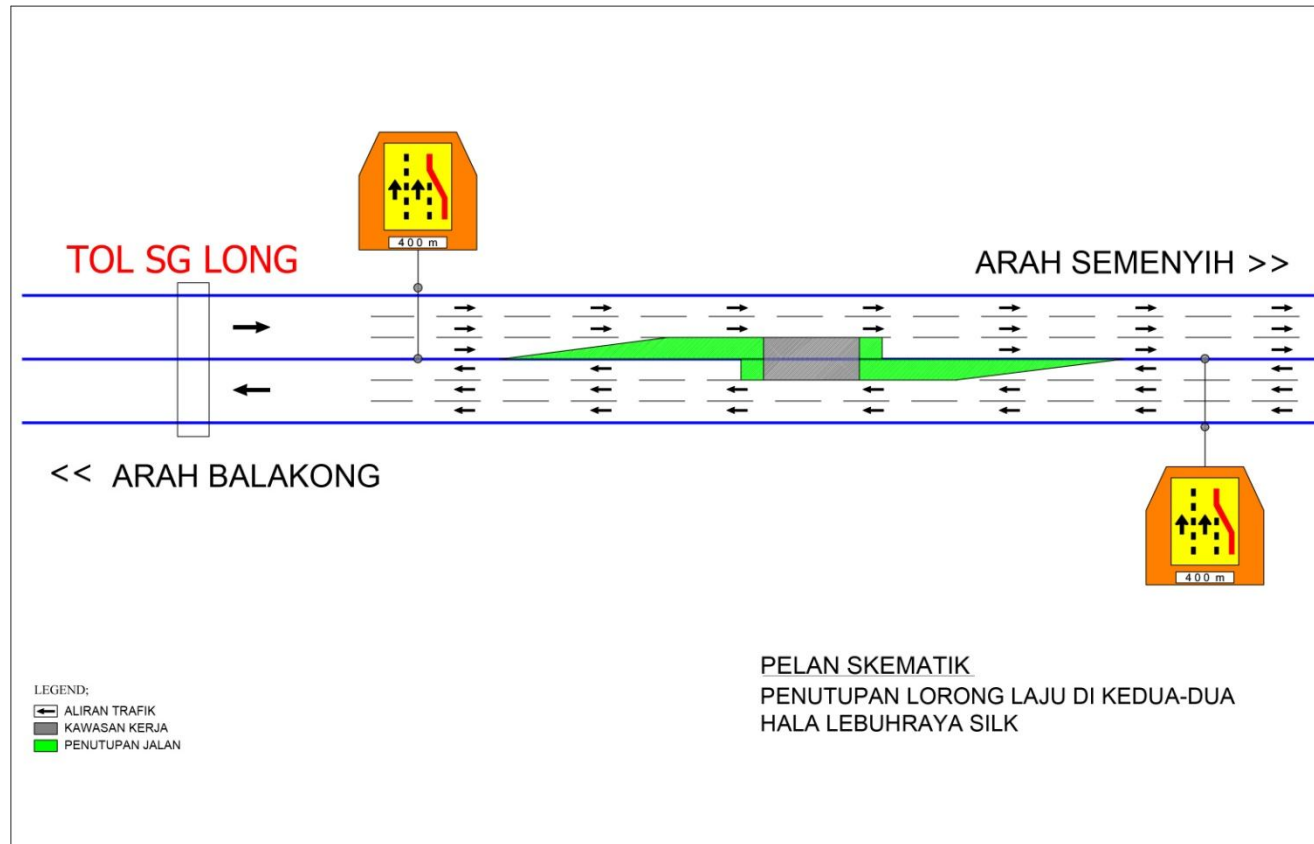

**LENCONGAN & PENUTUPAN SEMENTARA DI LEBUHRAYA SILK DI SUNGAI LONG (KM12) DARI 26 HB NOVEMBER 2017 SEHINGGA 20HB MAC 2018 UNTUK KERJA-KERJA PEMBINAAN JAMBATAN**

SELANGOR - EKVE Sdn Bhd mengumumkan penutupan lorong paling kanan bagi kedua-dua hala ke Semenyih dan Balakong Lebuhraya Silk di KM 12, Sg Long bermula dari **26hb November 2017 hingga 20hb Mac 2018** untuk kerja-kerja pembinaan jambatan bagi Lebuhraya EKVE.

Penutupan berkenaan akan dilaksanakan selama 24 jam sehari sehingga ke penghujung bulan Mac 2018.

Semua pengguna jalan dinasihatkan untuk mematuhi papan tanda jalan dan memandu dengan berhati-hati dalam kawasan tersebut.

Untuk sebarang pertanyaan, sila hubungi EKVE Hotline 1-300-88-3583 atau Pengarah Projek di talian 019-2272267.

Segala kesulitan amat dikesali. Terima kasih.